

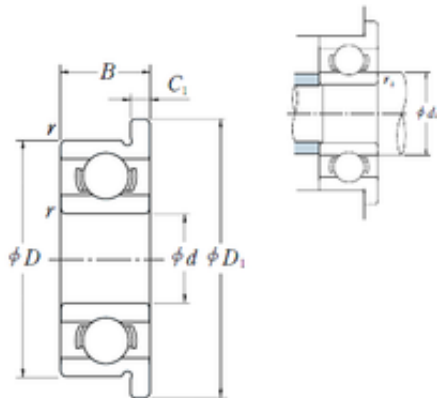

# CAR Bearing manufacturing Co.,Ltd

## NSK MF128 deep groove ball bearings



Bearing No. MF128

Size	8x13.2x2.5 mm
Bore Diameter	8 mm
Outer Diameter	13,2 mm
Width	2,5 mm
d	8 mm
D	12 mm
D1	13,2 mm
B	2,5 mm
r min.	0,15 mm
C1	0,6 mm
da min.	9,2 mm
ra max.	0,15 mm
Weight	0,82 Kg
Basic dynamic load rating (C)	545 kN
Basic static load rating (C0)	274 kN
(Grease) Lubrication Speed	40000 r/min
SRI	0.67
hidYobi	MF128
LangID	1
D_	12
SREX	0.02
C	0.545
B_	2.5
hidTable	ecat_NSESBMF
C0r	28
Oil rpm	48000

MF128 Bearing 2D drawings and 3D CAD models



## CAR Bearing manufacturing Co.,Ltd

SRE	0.67
mass	0.82
GRS rpm	40000
ra	0.15
SRIX	0.02
Cr	55
SRIN	0
C_1	0.6
C0	0.275
fo	15.914
SREN	0
D_1	13.2
DE_	11.1
Prod_Type3	ESM_MD_WF_OT
da	9.2
DA_	1.2
Z_	12
yobi	MF128
SDM_	9.9
r	0.15
KBRG	6102
DI_	8.7
B0	2.5